



Allison Offline Authentication USB Dongle Setup Guide

The purpose of the Allison Offline Authentication USB Dongle is to allow Allison DOC® and TCM Reflash to authenticate with the 6th Gen TCM when an active internet connection is not available (offline) or has a low grade/poor quality connection. The Allison Offline Authentication USB Dongle is not required when online and logged into Allison DOC® with an Allison HUB user ID or Allison TCM Reflash user ID.

Note: Allison OEM VCP users should refer to the VCP User Guide for information. The VCP User Guide is located on Allison HUB under the Engineering > VEPS Tools menu.

While the Allison Offline Authentication USB Dongle is intended for offline use, an active internet connection and an Allison HUB account or TCM Reflash account are required to activate and provision the dongle for the first time. To request an Allison HUB account visit <https://hub.allisontransmission.com/>.

NOTE: Due to the small size of the USB, it is recommended to attach the USB dongle to a lanyard.

To use your new USB dongle for the first time:

1. Insert USB dongle to PC's USB port and ensure the white LED illuminates. If it does not, remove and reinsert the USB dongle.
 - a. Open Allison DOC® or TCM Reflash
 - i. From Allison DOC®, go to the "Help" menu and select "Allison Security (6th Gen)", then select the "Advanced" button.
 - ii. From TCM Reflash, select the 6th Gen Database and then select the link in the lower corner.

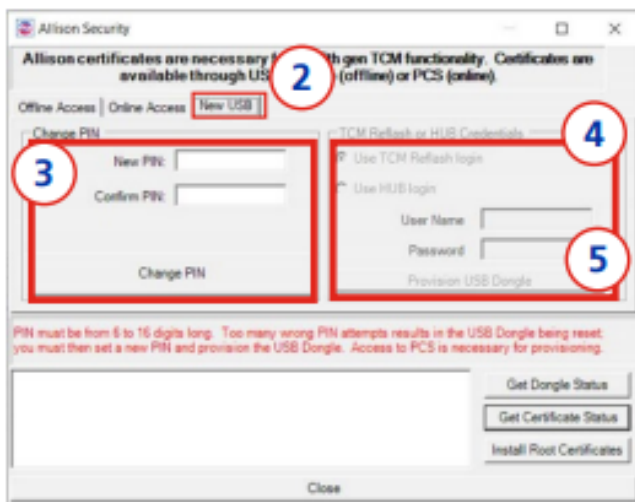

2. Click the "New USB" tab.
3. Enter your Pin in the "New Pin" and "Confirm Pin" boxes. Click the "Change Pin" button.
4. Indicate whether the credentials are for TCM Reflash or the Allison HUB by selecting the radio button.
5. Click Provision USB Dongle
6. A success message should appear and signs indicator is updated. This functionality fails if a new/reset USB dongle is not detected. The #signs are the number of 6th Gen TCM 'unlocks' allowed.

When the #signs are low, reprovision Allison Certificates on an existing USB dongle:

1. Insert USB dongle to PC's USB port
2. Access Allison Certificates dialog. Go to the "Online Access" tab.
3. Indicate whether the credentials are for TCM Reflash or the Allison HUB by selecting the radio button.
 - a. Enter Username and Password
4. Enter the USB dongle's PIN
5. Clicking the "Provision USB Dongle" button.
6. A success message will display after approximately one minute.

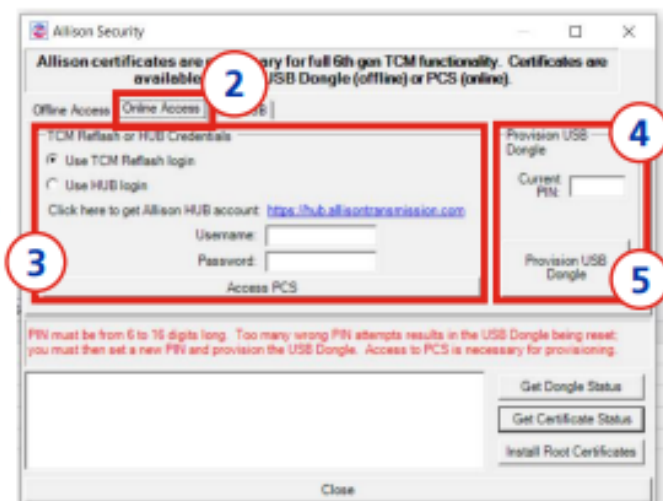

For support, please contact:

AllisonDOC@allisontransmission.com